



M SERIES

Single Cartridge Filter Housing

- Single Cartridge Filter Housings
- ASME Sec. VIII, Div. 1 & Non-Code Designs Available
- Universal

High pressure, multi-purpose, industrial ASME code ("U" & "UM") and non-code design housings.



SUITABLE USES



Air & Gas



Desalination



Coolant



Water



Electronics



Coatings



Oil & Gas



Chemical



Pulp & Paper



Power



Marine



Equipment

MEDIA Accepts one 10", 20", 30" or 40" long 2.5" or 2.75" OD filter element.

DESIGN PRESSURE /TEMPERATURE Rated up to 6150 PSIG.

AVAILABLE FINISHES Vessels available in carbon steel, stainless steel 304 or 316. Also available in LDX2101, C276, AL6XN, 2205, 2507 & Monel 400.

ADDITIONAL FEATURES Flange and socket weld connections. ASME U and UM stamps available.

Custom sizes, configurations, materials of construction and other options may be available. Please contact Fil-Trek

For drawings, flow charts, custom applications and filter cartridge information please visit www.fil-trek.com.

M SERIES

Single Cartridge Filter Housing

- Single Cartridge Filter Housings
- ASME Sec. VIII, Div. 1 & Non-Code Design
- Universal

HOUSING SPECIFICATIONS

Inlet/Outlet Sizes	0.75" or 1"
Inlet/Outlet Connection Type	Flange NPT Socket Weld
Vent	¼" NPT
Dirty Drain	¼" NPT
Max. Available Operating Pressure	6150 PSIG, see chart
Max. Available Operating Temperature	400°F, see chart
Finish	Carbon Steel - External Paint, "National Blue" Stainless Steel - Bead Blast
Certifications	ASME Section VIII, Div. 1 U, UM, CE, NB, CRN

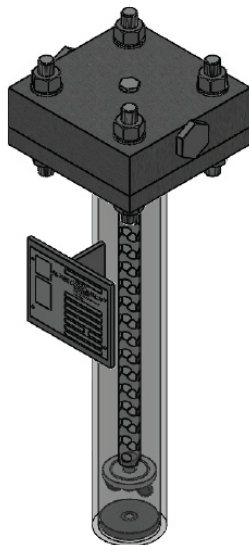

MODEL FLOW RATES

MODEL	LENGTH	FLOW RATE (GPM)
M001-1	10"	5
M001-2	20"	10
M001-3	30"	15
M001-4	40"	20

For maximum efficiency/product life, the flow rates are based on water at 5gpm/10". Actual Flow rate is dependent on fluid viscosity, cartridge micron rating, contaminant and type of media.

PRESSURE & TEMPERATURE DESIGNATION*

DESIGNATION	MOC	PSI	TEMP (°F)	ANSI RATING
PT1	CS	280	100	ANSI 150
	SS304/SS316	270		
PT2	CS	195	400	ANSI 150
	SS304/SS316	185		
PT3	CS	735	100	ANSI 300
	SS304/SS316	715		
PT4	CS	630	400	ANSI 300
	SS304/SS316	490		
PT5	CS	1475	100	ANSI 600
	SS304/SS316	1435		
PT6	CS	1260	400	ANSI 600
	SS304/SS316	990		
PT7	CS	2215	100	ANSI 900
	SS304/SS316	2155		
PT8	CS	1895	400	ANSI 900
	SS304/SS316	1485		
PT9	CS	3700	100	ANSI 1500
	SS304/SS316	3595		
PT10	CS	3165	400	ANSI 1500
	SS304/SS316	2480		
PT11	CS	6165	100	ANSI 2500
	SS304/SS316	5995		
PT12	CS	5275	400	ANSI 2500
	SS304/SS316	4130		

*Table above based on ANSI flange ratings. Fil-Trek will design based on application pressure and temperature requirements. **Max temperature may be limited to gasket material.

M SERIES

Single Cartridge Filter Housing

- Single Cartridge Filter Housings
- ASME Sec. VIII, Div. 1 & Non-Code Design
- Universal

HOUSING OPTIONS

*Indicates standard configuration

Configuration Options	(-) - Inline
Inlet/Outlet Sizes	0.75" 1"
Inlet/Outlet Connection Type	F - Flange P - NPT SW - Socket Weld
Finish Options	(-) - Paint "National Blue" (std for CS)* (-) - Bead Blast (std for SS304/SS316)*
O-Ring Options	(-) - Buna-N* ED - EPDM VI - Viton SI - Silicone TEV - Teflon encapsulated Viton
Design Pressure	150 PSIG* 300 PSIG

MODEL DIMENSIONAL DETAILS

MODEL	FLOW RATE (GPM)	WEIGHT (LBS)	A	B	C	D
M001-1	5	70	8"	3.5"	14.25"	16.75"
M001-2	10	80	8"	3.5"	24.25"	26.75"
M001-3	15	90	8"	3.5"	34.25"	36.75"
M001-4	20	100	8"	3.5"	44.25"	46.75"

Dimensions above are based on standard configuration. Contact factory for weights and dimensions for all other model configurations

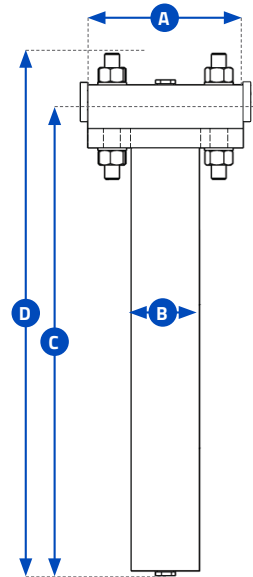

CHART LEGEND

- A** HEAD DIAMETER
- B** BODY DIAMETER
- C** INLET/OUTLET TO BASE
- D** OVERALL HEIGHT

PRODUCT NOMENCLATURE

S6	M	1	2	1	F	150
MATERIAL	MODEL	# OF FILTERS	FILTER LENGTH	CONNECTION SIZE & TYPE		DESIGN PRESSURE/TEMP RATING
(-) - Carbon Steel S4 - SS304 S6 - SS316	M - ASME Code EM - Non-Code	001 - 1	1 - 10" 2 - 20" 3 - 30" 4 - 40"	0.75 - 0.75" 1 - 1"	F - Flange P - NPT SW - Socket Weld	See chart on previous page

NOTE: The M series in an ASME code stamped housing. This vessel is also available in an industrial non-code design.

M SERIES

Single Cartridge Filter Housing

- Single Cartridge Filter Housings
- ASME Sec. VIII, Div. 1 & Non-Code Design
- Universal

FLOW CHARTS

